

NOMINAL SIZE	SDR	APPROXIMATE				
		DIMENSIONS (in.) / WEIGHT				
		WPR	A	B	C	D
4	7	335	8 3/4	8	4.5	4
	9	252				
	11	200				
	17	125				
6	7	335	10	9	6.625	4.5
	9	252				
	11	200				
	17	125				
8	7	335	13 1/2	12 1/2	8.625	6
	9	252				
	11	200				
	17	125				
10	7	335	13 3/4	12 1/2	10.75	7
	9	252				
	11	200				
	17	125				
12	7	335	14	12 1/2	12.75	7
	9	252				
	11	200				
	17	125				
14	7	335	16	14 1/2	14	7
	9	252				
	11	200				
	17	125				
16	7	335	16 1/4	14 1/2	16	7
	9	252				
	11	200				
	17	125				
18	7	335	17	15	18	8
	9	252				
	11	200				
	17	125				
20	7	335	17 1/4	15	20	9
	9	252				
	11	200				
	17	125				
22	7	335	18 1/2	16	22	9
	9	252				
	11	200				
	17	125				
24	7	335	20 3/4	18	24	10
	9	252				
	11	200				
	17	125				

REVISION HISTORY			
REV	DESCRIPTION	DATE	NAME

NOTES
1. TOLERANCES +/- 2". 2. ANGLE TOLERANCES +/- 2.0'. 3. MADE FROM HDPE SIZE SPECIFIC PIPE. 4. FOLLOW INDUSTRY STANDARD FUSION PROCEDURES. 5. FOLLOW INDUSTRY STANDARD QUALITY PROCEDURES. 6. CUSTOM DESIGN AVAILABLE. 7. IF SPECIFIC DIMENSIONS NEEDED, PLEASE CALL. 8. LARGER SIZES AVAILABLE UPON REQUEST. 9. WPR BASED ON PE 4710 FOR WATER AT 73° F.
CONFIDENTIAL NOTICE / CONTROLLED DOCUMENT
<small>*Dissemination of this information contained herein is prohibited*</small>

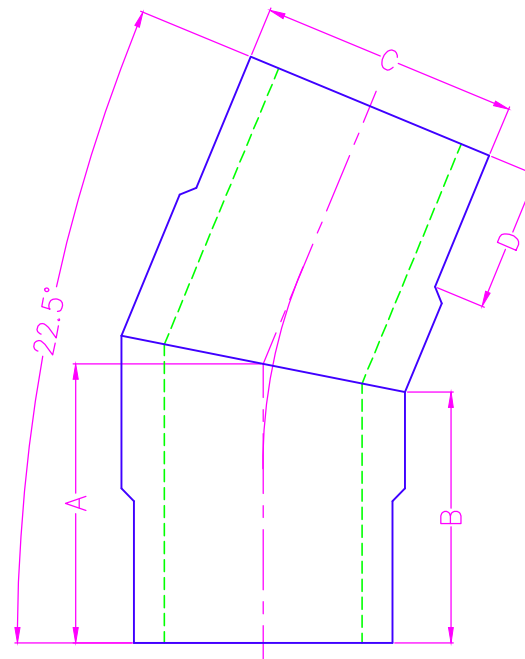

<h1 style="color: red; margin: 0;">SECOR</h1>	TITLE: FULL FLOW 22.5° ELL FABRICATED BY SECOR					
	17321 GROESCHKE ROAD HOUSTON, TX. 77084 PH. # 281-556-1661 FAX# 281-556-1683		DATE: 3/24/15	DRAWN BY: PATRICK O'GRADY	CHECKED BY:	DWG. NO.