

DIMENSIONAL DATA

SIZE IPS	TRUE O.D.	A	B	C MIN. WALL
4	4.50	6.00	9.00	.64
6	6.625	6.00	9.50	.94
8	8.625	6.50	10.00	1.23
10	10.75	6.50	11.00	1.53
12	12.75	8.00	13.00	1.82
14	14.00	9.00	13.50	2.00
16	16.00	9.00	14.00	2.28
18	18.00	9.00 </td <td>15.00</td> <td>2.57</td>	15.00	2.57
20	20.00	9.00	15.00	2.85
22	22.00	9.00	15.50	3.14
24	24.00	10.00	16.00	3.42

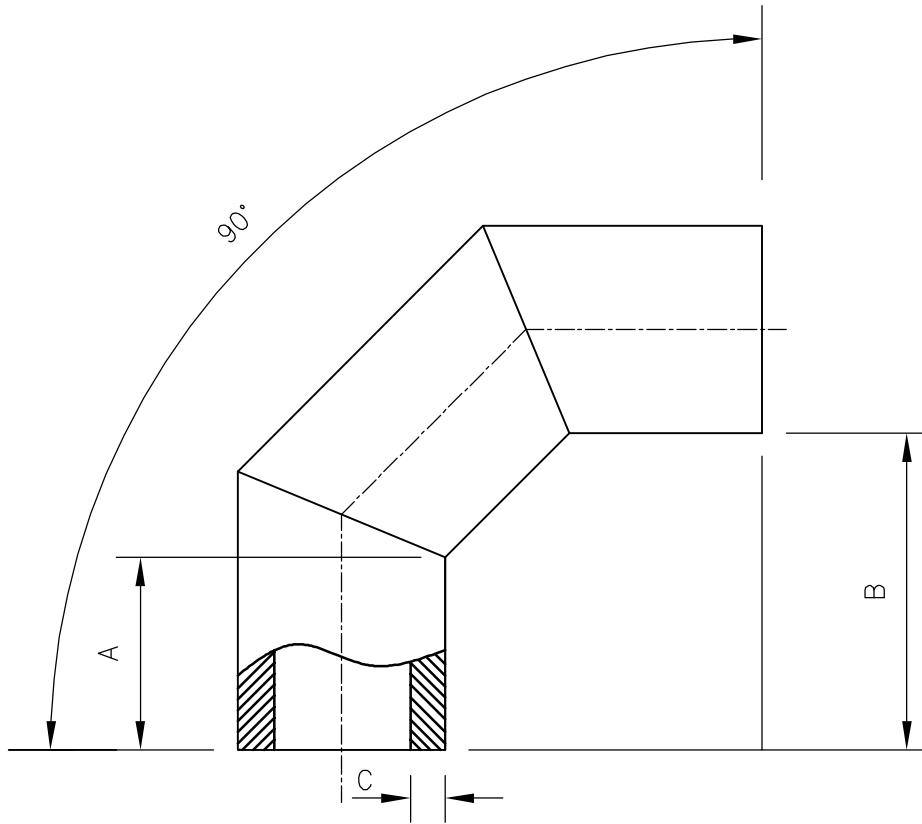

NOTES

1. TOLERANCES +/- 2.0" FOR DIMENSION "A" & "B" ONLY.
2. ANGLE TOLERANCES +/- 2.0'.
3. CLASS 200 - SDR.9 RATED.
4. REF. "C" MINIMUM WALL THICKNESS.
5. USE SDR.7 PIPE.
6. ENDS COUNTERBORED IF REQUESTED.
7. USE APPROVED VENDORS FOR PIPE.
 - WL PLASTICS
 - INDEPENDENT PIPE
 - POLY PIPE
8. FOLLOW SECOR FUSION PROCEDURES.
9. FOLLOW SECOR QUALITY PROCEDURES.
10. NOTIFY FM APPROVALS OF CHANGES.
11. CUSTOM DESIGN AVAILABLE.

CUSTOM LENGTH "A": _____

CUSTOM LENGTH "B": _____

CONFIDENTIAL NOTICE / CONTROLLED DOCUMENT

Dissemination of this information contained herein is prohibited

SECOR

17321 GROESCHKE ROAD HOUSTON, TX. 77084
 PH. # 281-556-1661 FAX# 281-556-1683

90° ELL. 3 SEGMENT
 CLASS 200

DATE:	DRAWN BY:	CHECKED BY:	DWG. NO.	REV.
3/6/10	CRAIG STEVENS	DAVID NIX	SEC-512-03-200	D