

| DIMENSIONS |     |     |           |       |      |      |
|------------|-----|-----|-----------|-------|------|------|
| SIZE DIPS  | SDR | WPR | TRUE O.D. | A     | B    | C    |
| 6"x4"      | 7   | 336 | 6.90      | -     | -    | -    |
|            | 9   | 252 |           | -     | -    | -    |
|            | 11  | 200 | X         | 11.41 | 5.10 | 4.33 |
|            | 17  | 126 | 4.80      | -     | -    | -    |
| 8"x6"      | 7   | 336 | 9.05      | -     | -    | -    |
|            | 9   | 252 |           | -     | -    | -    |
|            | 11  | 200 | X         | 12.79 | 6.10 | 5.12 |
|            | 17  | 126 | 6.90      | -     | -    | -    |

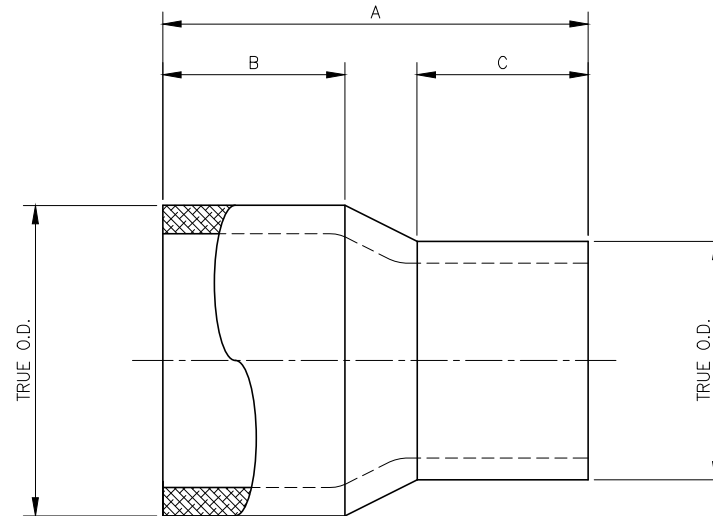

**CONCENTRIC REDUCER**

SCALE: NTS

**NOTES**

1. ALL DIMENSIONS ARE IN INCHES.
2. FITTINGS ARE MANUFACTURED AND TESTED TO THE REQUIREMENTS OF ASTM D2513 AND ASTM D2683.
3. FITTINGS ARE MOLDED FROM VIRGIN BLACK HIGH DENSITY RESIN IN ACCORDANCE WITH ASTM D3350.
4. FITTINGS MEET AWWA C906 TESTING REQUIREMENTS.
5. FITTINGS ARE ASTM D3261 AND NSF-61 APPROVED.
6. FITTINGS PRESSURE RATED FOR NATURAL GAS AND POTABLE WATER.
7. DIMENSIONAL TOLERANCE: +/- .2".
8. ANGLE TOLERANCES: +/- 2.0'.

| A   | ISSUED FOR CLIENT REVIEW | -  | CMG             |
|---|--------------------------|--|-----------------|
| REV   | DESCRIPTION              | DATE   | NAME            |
| <b>SECOR</b>  |                          |  |                 |
| 17321 GROESCHKE ROAD HOUSTON, TX. 77084<br>PH.# 281-556-1661 FAX# 281-556-1683                                  |                          |  |                 |
| CONFIDENTIAL NOTICE / CONTROLLED DOCUMENT<br>*Dissemination of this information contained herein is prohibited* |                          |  |                 |
| TITLE:  |                          | SECOR<br>DIPS MOLDED FITTING<br>CONCENTRIC REDUCER |                 |
| DATE  | DRAWN BY                 | CHECKED BY   | DRAWING NO. REV |
| 10/15/20  | CMG                      | -  | - A             |