

DIMENSIONS						
SIZE IPS	SDR	WPR	TRUE O.D.	A	B	C
3"x2"	7	336	3.500	9.37	3.13	3.13
	9	252		9.37	3.13	3.13
	11	200	X	9.37	3.13	3.13
	17	126	2.375	9.37	3.13	3.13
4"x3"	7	336	4.500	8.62	3.13	3.13
	9	252		8.62	3.13	3.13
	11	200	X	8.62	3.13	3.13
	17	126	3.500	8.62	3.13	3.13
4"x2"	7	336	4.500	11.53	3.00	3.00
	9	252		11.53	3.00	3.00
	11	200	X	7.88	3.13	3.13
	17	126	2.375	7.88	3.13	3.13
6"x4"	7	336	6.625	9.13	4.22	3.75
	9	252		9.13	4.22	3.75
	11	200	X	9.50	4.38	3.75
	17	126	4.500	9.50	4.38	3.75
8"x6"	7	336	8.625	10.70	5.00	4.64
	9	252		10.70	5.00	4.64
	11	200	X	11.81	6.00	6.00
	17	126	6.625	11.81	5.06	4.75
10"x8"	7	336	10.750	16.00	6.00	6.00
	9	252		16.00	6.00	6.00
	11	200	X	14.86	6.62	6.25
	17	126	8.625	14.86	6.62	6.25
12"x10"	7	336	12.750	14.88	6.63	6.25
	9	252		14.88	6.63	6.25
	11	200	X	15.00	6.63	6.25
	17	126	10.750	15.00	6.63	6.25
12"x8"	7	336	12.750	16.54	7.09	6.10
	9	252		16.54	7.09	6.10
	11	200	X	16.54	7.09	6.10
	17	126	8.625	16.54	7.09	6.10

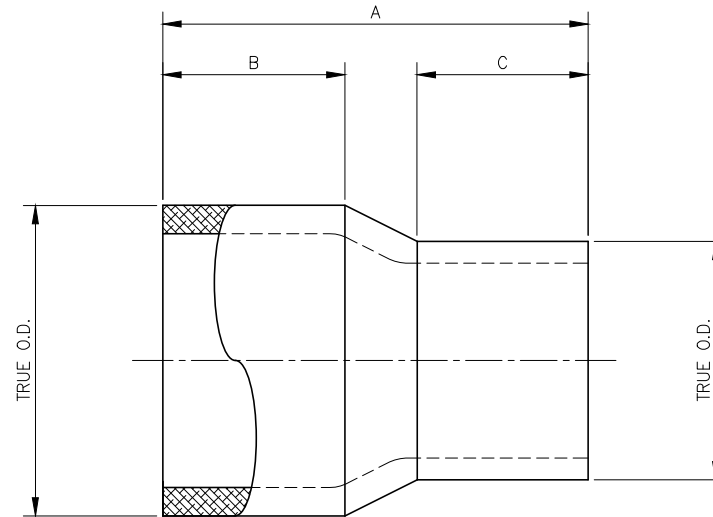

CONCENTRIC REDUCER

SCALE: NTS

A	ISSUED FOR CLIENT REVIEW	-	CMG
REV	DESCRIPTION	DATE	NAME

SECOR

17321 GROESCHKE ROAD HOUSTON, TX. 77084
PH.# 281-556-1661 FAX# 281-556-1683

CONFIDENTIAL NOTICE / CONTROLLED DOCUMENT
Dissemination of this information contained herein is prohibited

TITLE: **SECOR**
IPS MOLDED FITTING
CONCENTRIC REDUCER

DATE	DRAWN BY	CHECKED BY	DRAWING NO.	REV
10/15/20	CMG	-	-	A

NOTES

1. ALL DIMENSIONS ARE IN INCHES.
2. FITTINGS ARE MANUFACTURED AND TESTED TO THE REQUIREMENTS OF ASTM D2513 AND ASTM D2683.
3. FITTINGS ARE MOLDED FROM VIRGIN BLACK HIGH DENSITY RESIN IN ACCORDANCE WITH ASTM D3350.
4. FITTINGS MEET AWWA C906 TESTING REQUIREMENTS.
5. FITTINGS ARE ASTM D3261 AND NSF-61 APPROVED.
6. FITTINGS PRESSURE RATED FOR NATURAL GAS AND POTABLE WATER.
7. DIMENSIONAL TOLERANCE: +/- 2".
8. ANGLE TOLERANCES: +/- 2.0'.